

STANDARD FUME HOODS



These fume hood superstructures are equipped with stainless steel air by-pass grilles and are designed to maintain constant air removal regardless of sash position. The exterior of these double wall superstructures is fabricated of electro zinc plated steel with an acid resistant finish. The flush lined interior has a vapor proof fluorescent light fixture above. The counter-balanced stainless steel sash has safety glass. Jamb posts and track are of stainless steel.

The 1-1/4" thick works tops, fixtures and base cabinets are sold separately. The customary accessories sold with the work top and base unit are a oval cup sink, flush plate light switch, blower switch with a pilot light, two 110 volt AC outlets, and remote controlled valves for a cold water gooseneck, gas, air and vacuum pedestals.

Overall dimensions including base cabinet and top are 30" wide 7'-2" high, and length as chosen.

Superstructure FUM-194 has an 88" unobstructed interior length.

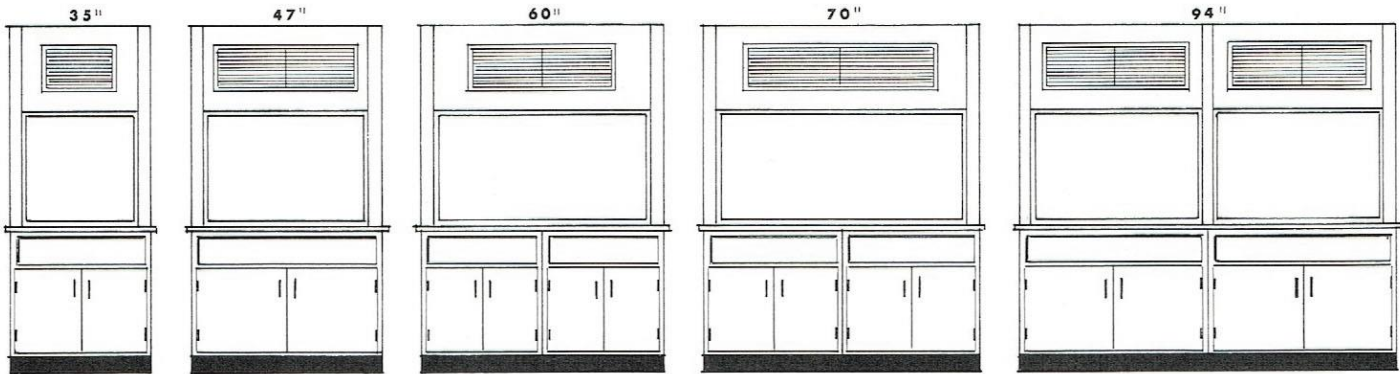

FUM-135

FUM-147

FUM-160

FUM-170

FUM-194

Because of their economical design and performance, standard fume hoods have wide acceptance. Their functional simplicity is a factor that promotes their use not only school. Laboratories, but also in industrial installations. Services can vary to meet the requirements of the particular laboratory process involved. Complete mechanical roughing-in information on every hood is furnished upon request.