

## INDUCED AIR FUME HOODS

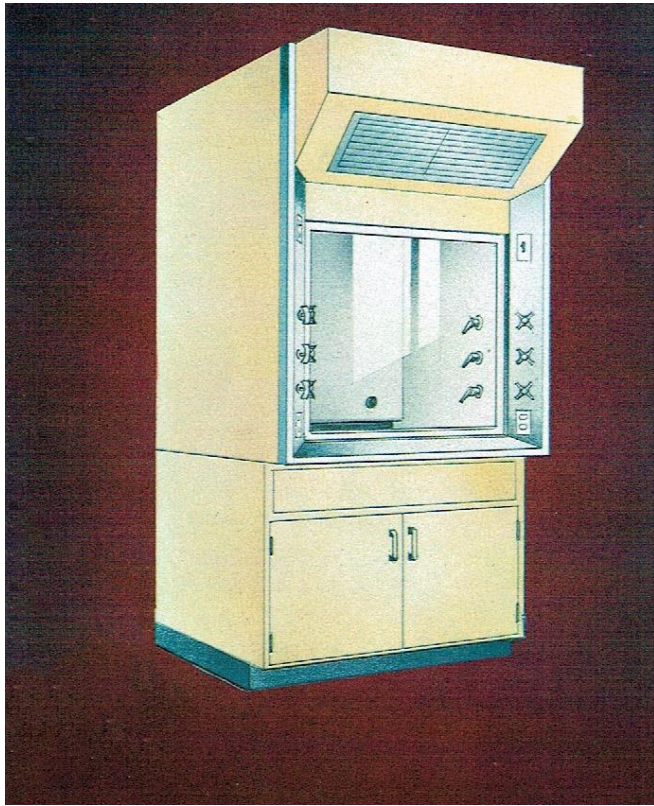

To reduce the waste of costly air conditioned comfort in a laboratory, these hoods are provided with an auxiliary air supply duct feeding 50% of air volume used to the face of the hood via the stainless steel air supply grille above. The front posts and track as well as the lower fil with concealed air by-pass are of stainless steel.

The lined flushed interior, with lower and upper adjustable baffles is illuminated by vapor proof fluorescent light fixture above. The counter-balanced stainless steel sash has safety glass.

Accessories include a blower switch with pilot light, a light switch, four 110 volt AC outlets, and remote controlled valves for two cold water, two gas, and two air cocks. Additional or different services are available upon request.

The 1-1/4" thick tops and base cabinet understructures are sold separately. The working tops are offered with an oval cuP sink.

Overall dimensions including base cabinet and top are 41" wide 7'-11-1/4" high, and length as chosen.

Superstructure FUM-394 has an 82" unobstructed interior length.

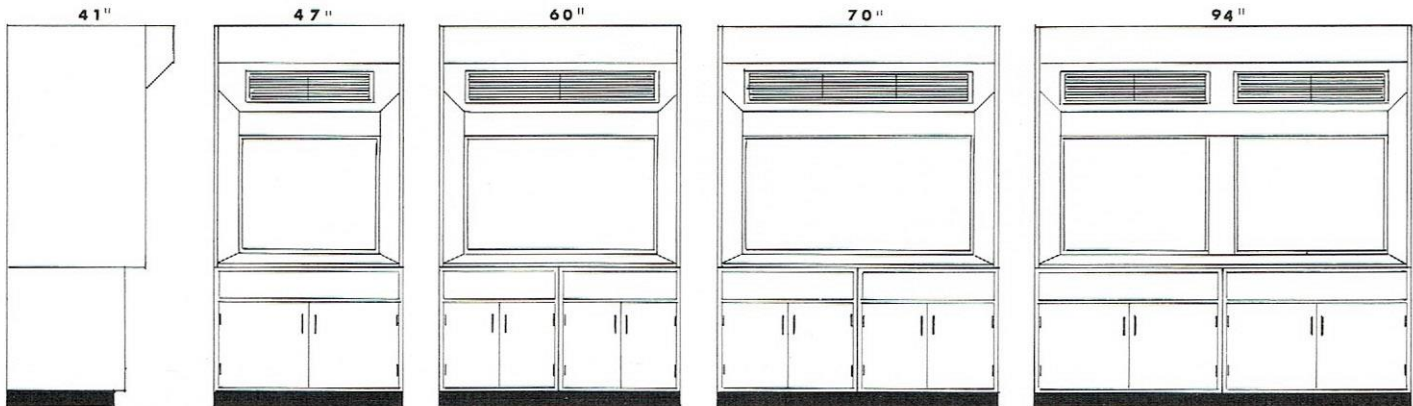

END VIEW

FUM-347

FUM-360

FUM-370

FUM-494

The constantly changing requirements of laboratory research demand flexibility. Louie Specialty Works has designed and built many custom fume hood installations that have met specific intricate requirements of laboratory processes, retaining flexibility for future modifications. Custom design of fume hoods is available upon request, since it has been a welcome challenge by the firm.